



Standard Operating Procedure (SOP)

This SOP should be consulted during all operations & maintenance of the equipment, however, does not replace the necessary training performed by authorized personnel prior to usage.

Equipment Manufacturer:	Drill Driver
Model:	
Process:	Drilling holes
Process comments:	

Typical Process Flow Chart:

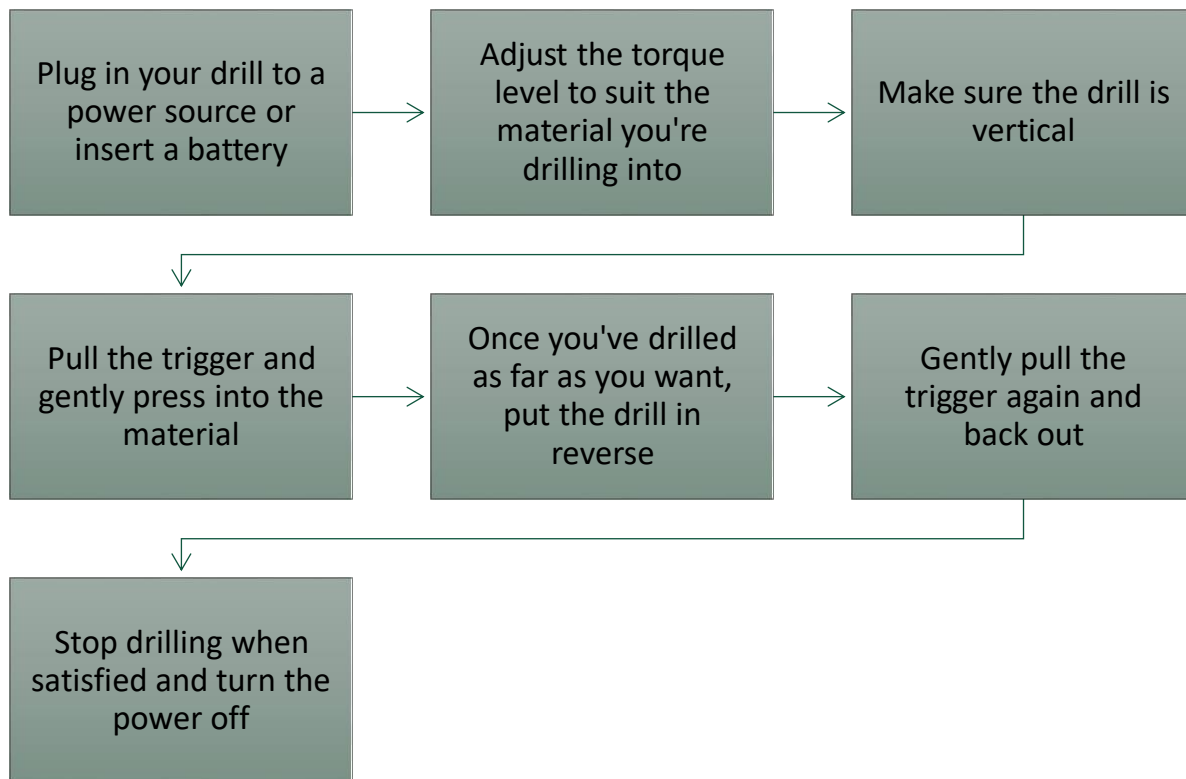

Important Reminders:

- Know what torque your material requires.
- If you're concerned about over-screwing, stop drilling and finish off with a screwdriver instead.